



Galvanized Backplate

Technical Manual

Galvanized backplate with two wall elbows and mounting plugs, for drywall construction

Description

- 1 Phillips Countersunk Self-Tapping Screw (M4×35)
Quantity: 6

- 2 Drywall expansion sleeve anchor (12×30)
Quantity: 6

- 3 Female elbow (16×1/2 or 20×1/2)
Quantity: 2

- 4 Galvanized backplate
Quantity: 1

- 5 Hollow wall anchor expansion screw (M4×60)
Quantity: 6

- 6 Phillips pan head screw (M4×6)
Quantity: 6

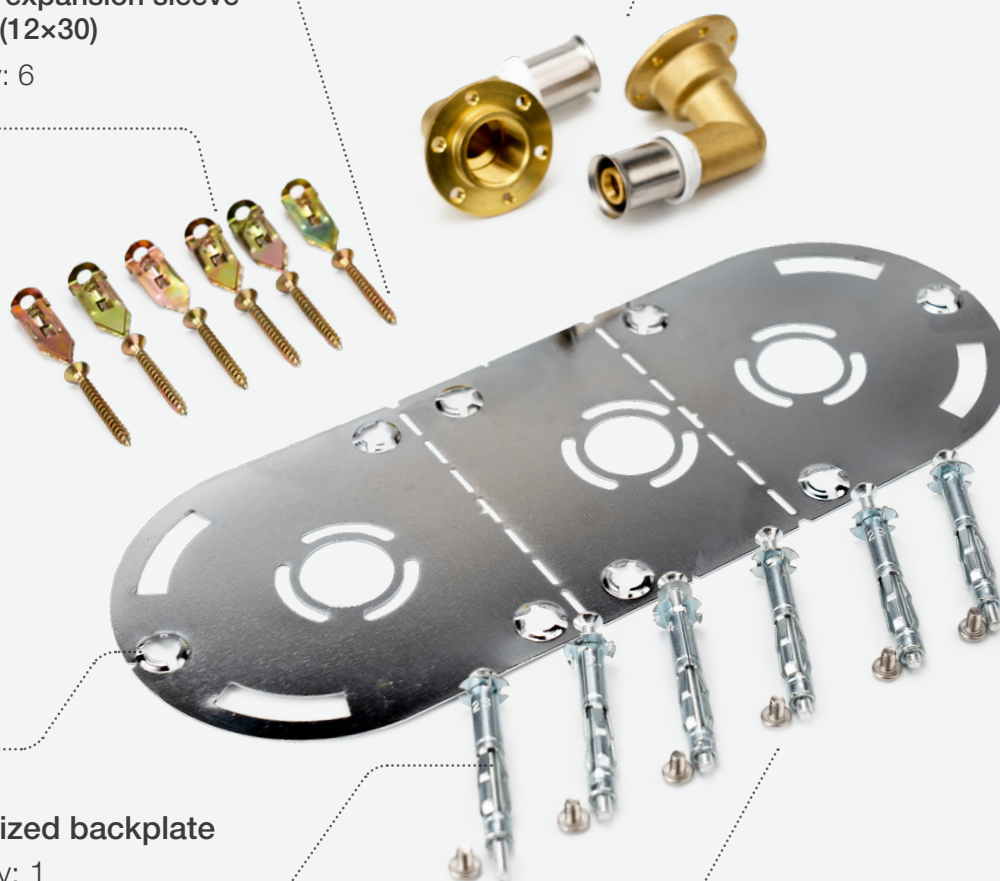

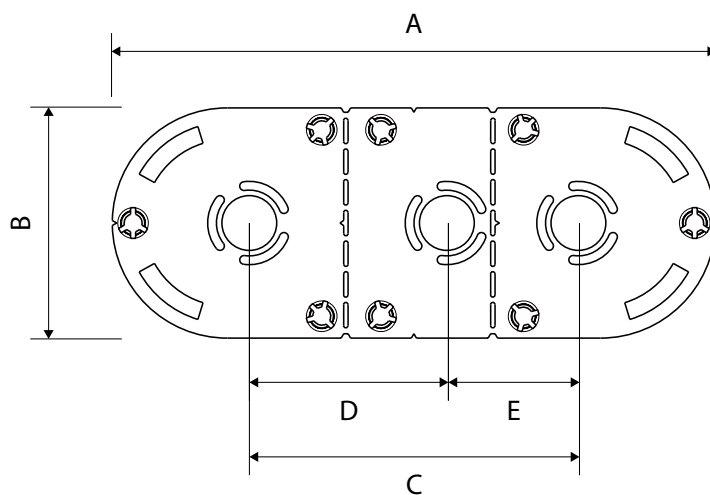

| A | B | C | D | E |
|-----|-----|-----|----|----|
| 275 | 105 | 150 | 90 | 60 |

Highlights

3-in-1 System

- Galvanized steel plate that can be manually split for 3 possible mounting options.
- Storage savings (number of boxes).
- Financial savings.

Choice of Fixing System

- 6 metal expansion anchors.
- 6 nail-in anchors.

Quick Positioning

- 6 vertical and horizontal positioning markers for easy and quick placement of the plate.

Recessed Screw Heads

- 8 curved slots specially designed to accommodate screw heads.
- 4 positioning notches.
- No unscrewing of anchor screws.
- No adhesive over-thickness.



150 mm center distance for
sanitary fittings

or



60 mm center distance
for washbasin or sink + 1
single-hole plate

or



2 single-hole plates

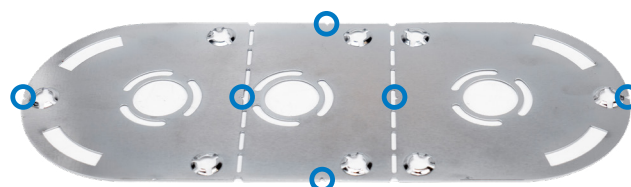

Assembly

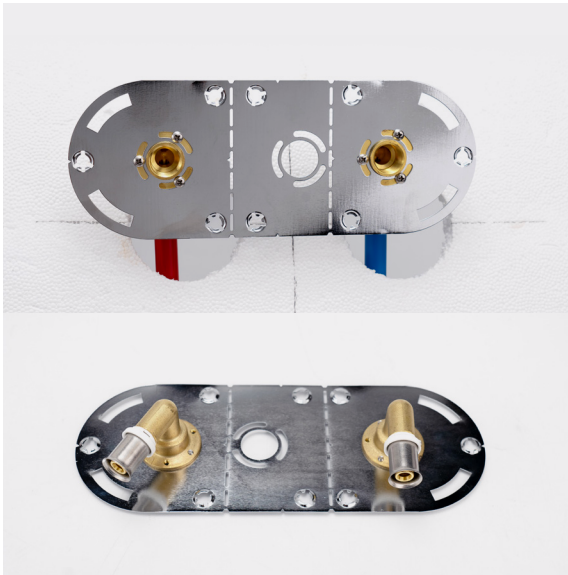

Step 1:

Secure the elbow fittings to the support without tightening them (Maximum Ø63 drilling).

The direction of the fitting can be adjusted as needed.

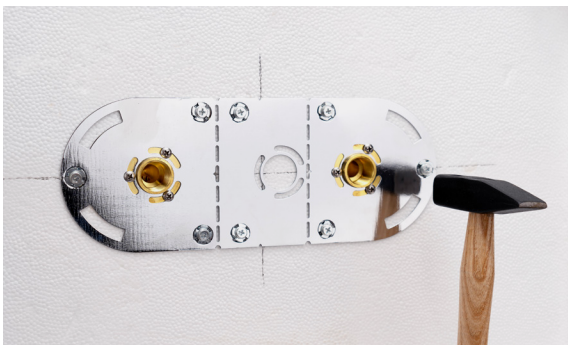

Step 2:

Place the anchors (nail-in or expansion) in the provided curved fixing locations.



Step 3:

Permanently lock the screws holding the fittings.

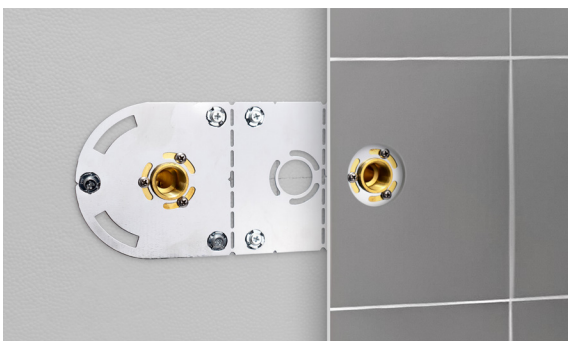

Step 4:

Tiling is easy, as the screw heads do not protrude from the surface.